

GEARHEADS

CONNECTION DIAGRAMS

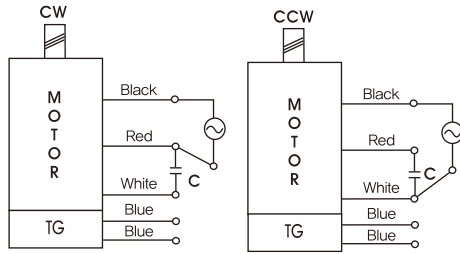

※The direction of motor rotation is as viewed from the front shaft end of the motor

DIMENSIONS

K8G□B(C)



K8RG25N□-SP + K8G□B(C)



DECIMAL GEARHEAD
K8G10BX

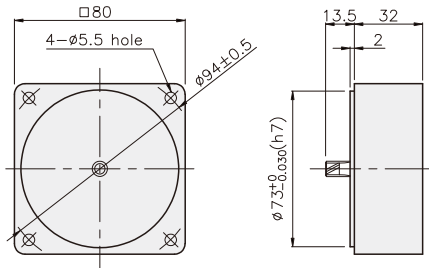

GEARHEAD
K8G□B(C)

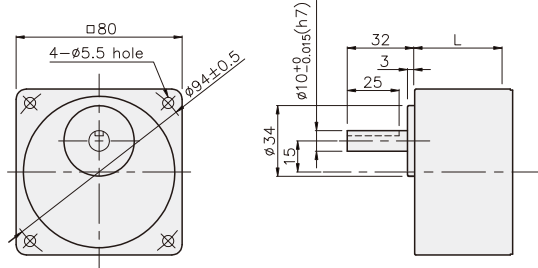

KEY SPEC

● KEY

● KEY GROOVE

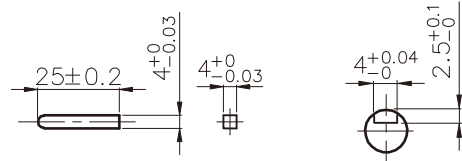

DIMENSION TABLE

PART No.	L	Application Model	Mounting BOLT
01	32	K8G3~18B(C)	M5 P0,8 X 50
02	42,5	K8G20~250B(C)	M5 P0,8 X 65
03	32	K8G10BX	M5 P0,8 X 95

WEIGHT

PART	WEIGHT(kg)
MOTOR	1,60
DECIMAL GEAR HEAD	0,46
GEAR HEAD	
K8G3~18B(C)	0,51
K8G20~40B(C)	0,64
K8G50~250B(C)	0,70

K8RG25N□-SP + K8G□B(C)

