

## K42-TYPE

## Planetary GEARHEAD

### DIMENSIONS

#### K42-4266 SERIES

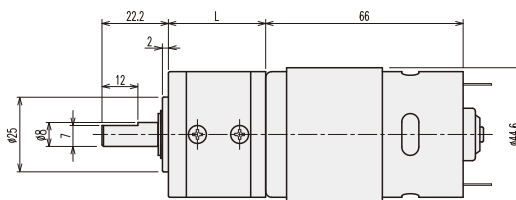
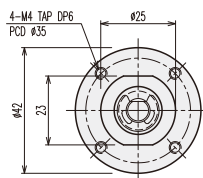

GEARHEAD LENGTH

RATIO	L	RATIO	L
1/4	32.5	1/212 ~ 1/864	52.6
1/14 ~ 1/24	39.2	1/1062 ~ 1/3600	59.3
1/49 ~ 1/144	45.9		

#### MOTOR PERFORMANCE DATA

MODEL	ITEM	VOLTAGE (DC)	NO LOAD		AT MAX. EFF.			STALL		WEIGHT (g)
			A	rpm	gf-cm	A	rpm	A	kgf-cm	
KD4266T1		12V	1	7000	520	3.8	5900	24	3.8	350
KD4266T2		24V	0.5	7000	520	1.8	5900	13	4.3	

#### AT MAXIMUM EFFICIENCY (K42-□□□□-KD4266T□)

GEAR	MODEL	KD4266T1		KD4266T2	
		DC 12V		DC 24V	
		rpm	kgf-cm	rpm	kgf-cm
1/0004		1470	1.7	1470	1.7
1/0014		420	4.9	420	4.9
1/0017		346	5.9	346	5.9
1/0024		245	8.4	245	8.4
1/0049		120	14	120	14
1/0061		96	17	96	17
1/0084		70	24	70	24
1/0104		57	29	57	29
1/0144		41	30	41	30
1/0212		28	30	28	30
1/0263		22	30	22	30
1/0294		20	30	20	30
1/0504		11.7	30	11.7	30
1/0624		9.4	30	9.4	30
1/0720		8.2	30	8.2	30
1/0864		6.8	30	6.8	30
1/1062		5.5	30	5.5	30
1/1470		4	30	4	30
1/2500		2.35	30	2.35	30
1/3000		1.96	30	1.96	30
1/3600		1.63	30	1.63	30

※ 出力軸の回転方向は、モーターの回転方向と同じです。